

**Congratulations on your purchase and welcome to us. The portable mist enhances the existing moisturizing routine and provides an instant hydration. Enjoy moisturizing and refreshing your skin anytime anywhere.**

#### How to use:

Note: If you wear glasses, make sure you take them off before starting the treatment.

1 Open the water tank lid before filling in water.

2 Fill in distilled water into the water tank.

Always use distilled water in the appliance. Other types of water may affect the misting performance.

Depending on your usage time, a full tank will approximately provide 2-5 treatments.

3 To turn on the appliance, push downwards the sliding cover until a "click" is heard. The power-on indicator lights up.

4 Place the appliance at the distance of 5-10cm away from your face. Keep moving the appliance in a circular movement and enjoy the mist.

Note: The spray will be automatically stopped after 30 seconds of continuous operation.

5 To turn off the appliance, simply slide the cover back.

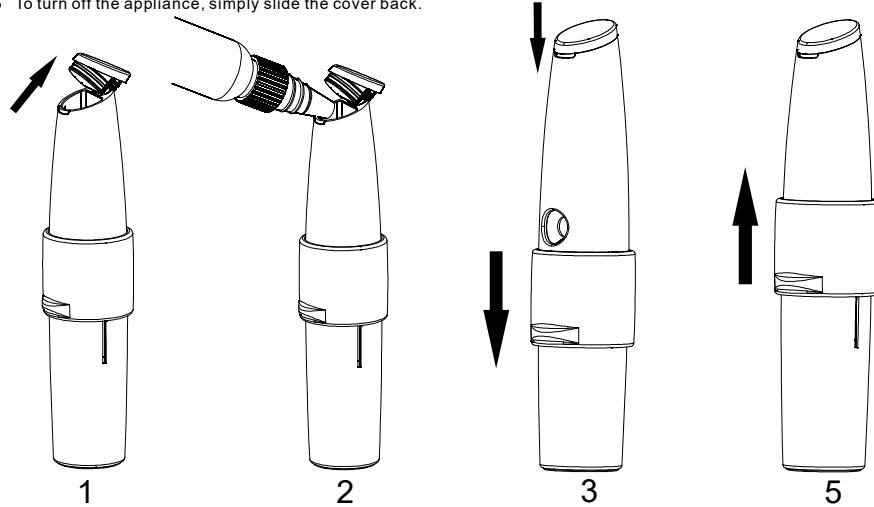

#### Important

- Read this user manual carefully before you use the appliance and keep it for future reference.
- Only use the appliance as described on this user manual.
- Keep the USB cable dry.
- Do not insert material into the USB socket to avoid short circuiting.
- Do not use the USB cable if it is damaged.
- Always use the distilled water. Do not use tap water or any uncleaned water. Do not add toner and other cosmetic products to the appliance.
- Do not use hot water. Always use water in cool or room temperature.
- Do not use the appliance with self-made cleaners, creams, oils or cosmetic products containing harsh chemicals or rough particles.
- Regular cleaning of the appliance ensures optimal results and a longer life of the appliance.
- If you do not utilize all the water within one day, you may keep it in the water tank but DO NOT keep it for more than 3 days. You must clean the water tank thoroughly after 3 days.
- If you do not use the appliance for a certain period of time, dispose any remaining water out and air dry the tank.
- Do not block the nozzle of the mist while in use.
- Do not put the appliance or any part in the dish washer.
- Children shall not play with the appliance. Cleaning and user maintenance shall not be made by children without supervision.
- Stay away from magnetic source to prevent from unintended operation.
- This appliance contains battery that is non-replaceable.
- This appliance must only be supplied at safety extra low voltage corresponding to the marking on the appliance.

#### Electromagnetic fields (EMF)

This appliance complies with all applicable standards and regulations regarding exposure to electromagnetic fields.

#### Recycling

- This product shall not be disposed of with normal household waste.
- This product contains a built-in rechargeable battery which shall not be disposed of with normal household waste. We strongly advise you to take your product to an official collection point or a service centre to have a professional remove the rechargeable battery.
- Follow your country's rules for the separate collection of electrical and electronic products and rechargeable batteries.
- Correct disposal helps prevent negative consequences for the environment and human health.
- Do not throw away the product with normal household waste at the end of its life, but hand it in at an official collection point for recycling. By doing this, you help to preserve the environment.
- This product contains a built-in rechargeable battery which shall not be disposed of with normal household waste.
- Follow the instructions in section "removing the rechargeable battery" to remove the battery.

#### Removing the rechargeable battery

Only remove the rechargeable battery when you discard the product. Before you remove the battery, make sure that the product is disconnected from the wall socket and that the battery is completely empty.

Take any necessary safety precautions when you handle tools to open the product and when you dispose of the rechargeable battery.

Do not connect the appliance to the USB port again after you have removed the battery.

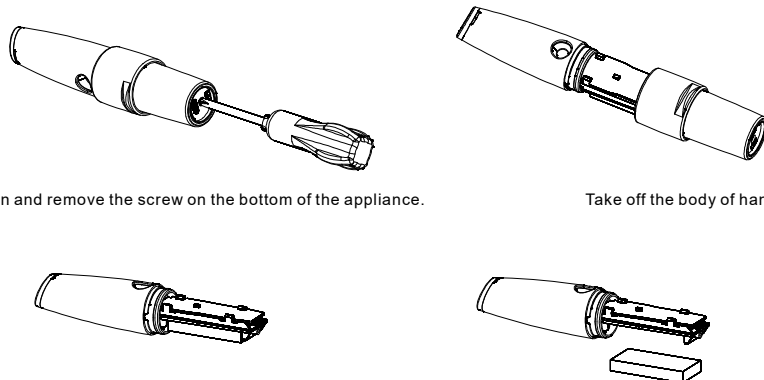

Loosen and remove the screw on the bottom of the appliance.

Take off the body of handle.

Cut the battery tags or use a flat-head screw driver to pry it loose and then remove the rechargeable battery carefully.

## Overview

1. Mist outlet
2. Handle
3. USB port
4. USB port cover
5. Sliding cover
6. Water tank
7. Water tank lid
8. USB cable

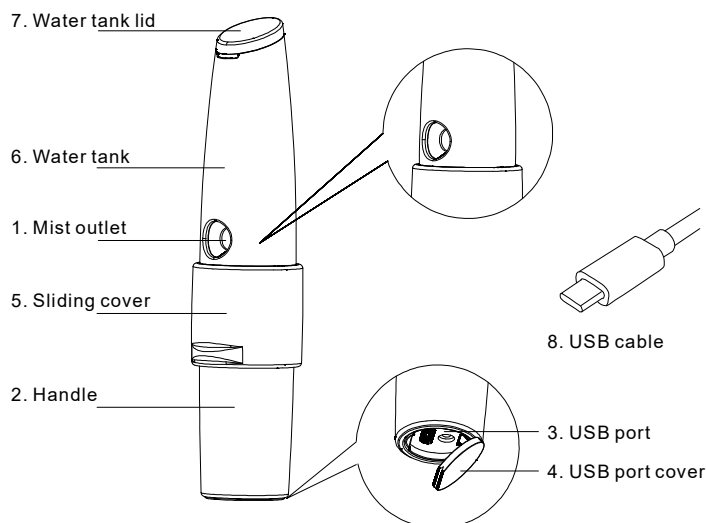

## How to use

Before use:

Charging the appliance

Make sure the appliance is fully charged before you use it for the first time. It takes approximately 2.5 hours to fully charge the appliance. A fully charged appliance approximately provides 30 treatments.

- 1 Make sure the sliding cover is closed.
- 2 Insert the micro USB plug in the socket of the appliance and put the USB plug into the charging device. The appliance can't be used while charging. During charging, the indicator keeps blinking.
- 3 When the battery is fully charged, the charging indicator stops blinking.

Note: Always close the USB port cover after charging or during cleaning.

Battery-low indicator

When the battery is almost empty( i.e less than 3 applications ), the charging indicator flashes during use. When the battery is empty, the appliance switches off right away.

Tips and Tricks:

- 1 If further usage is needed, please push the sliding cover upward and then push the downwards to re-start the unit.
- 2 If you wish to stop in the middle of the treatment, simply push the sliding cover upwards.
- 3 The appliance should be hold vertically for optimal performance. When the appliance is tilted or upside down, mist may not be able to be generated.
- 4 Mist volume may be different during usage and it is normal to use.
- 5 Wind from air conditioner or electric fan may affect and change mist direction. To optimize misting performance, please avoid wind from air conditional or electric fan while using the appliance.
- 6 Droplets of water may be generated at mist hole and this is normal. But if many water droplets remain at mist hole, it may affect the mist volume. Please remove water droplets with tissue paper immediately.
- 7 If you plan not to use the appliance for a period of time, clean the unit thoroughly before storage.
- 8 Do not use detergent, nail polisher remover etc, to clean the appliance.

After use:

- 1 Clean the appliance with tissue paper or clean towel, especially the mist outlet.
  - 2 Clean the water tank with tap water if necessary.
- It's highly recommended to empty the water tank and clean the appliance every day.
- 3 Always make sure the USB cover is closed before cleaning
  - 4 Keep it in a safe and dry place.

## Troubleshooting

This chapter summarizes the most common problems you could encounter with the appliance. If you are unable to solve the problems with the information below, please contact the consumer care center in your country.

Problems	Solution
The appliance does not charge	Make sure the socket or the USB port to which you connect the appliance or micro USB is live.If the appliance is fully discharge, please charge the appliance for a few minutes to activate the appliance to charge up. When the charging light on the appliance still does not light up or when the appliance still does not charge, take it to your dealer or the nearest Service Center.
The appliance does not work anymore	Make sure the sliding cover locked in place. Charge the appliance according to the instructions in this user manual. The appliance cannot operate during charging , please remove the USB cable. Shake the appliance gently during use.
Less/No mist comes out from the appliance,or the mist is weak.	Make sure you use distilled water in the appliance.Do not use other type of liquid as it may affect the misting performance.Clean the mist outlet with tissue paper.Shake the appliance gently during use.
The appliance has abnormal noise during use.	The water level may be low, please refill the water tank.
The appliance may start working unconsciously	Please put it away from magnetic source, such as the lock of your handbag, etc.
Water drips from the mist hole	We highly recommend to open the cap of the bottled water and let water sit a bit before filling up the water tank.

## Guarantee and service

If you need information e.g. about replacement of an attachment or if you have a problem, please contact the Consumer Care Center in your country. If there is no Consumer Care Center in your country, go to your local dealer.